

Weckenmann Anlagentechnik GmbH & Co. KG, 72358 Dormettingen, Germany

Saudi precast company Inshaa Precast invests in high-quality tilting table production for the expansion of production capacities

Since its establishment in 2008 the young precast plant Inshaa Precast, based in Al-Khobar in the eastern province of Saudi Arabia, has steadily gained itself a very good reputation as a manufacturer of high-quality precast elements. The company site extends over an area of more than 60,000 m², on which Inshaa Precast, which belongs to RCC Construction Co. Ltd., annually produces more than 500,000 m² pre-stressed hollow-core slabs and processes more than 40,000 m³ concrete for a wide range of precast elements.

■ Daniel Breitbach, Weckenmann Anlagentechnik GmbH & Co. KG, Germany ■

In its still relatively young history, the company has been able to implement numerous well-respected projects, such as the King Fahad Specialist Hospital in Dammam, housebuilding projects for the Royal Commission of Jubail and Yanbu, several public buildings and numerous mosques as well as private houses and commercial buildings.

High-quality precast products

Whereas the complete range of floors from 150 to 500 mm in lengths of up to 23 m can be manufactured in the prestressed hollow-core slab production, the company concentrates in the modern tilting table pro-

duction on sophisticated architectural concrete projects such as wall elements and perimeter walls as well as the manufacture of structural precast elements. The company also successfully applies modern decorative technologies such as washed concrete techniques and other surface treatment processes in the implementation of its different projects.

Quality – made in Germany

The implementation of these sophisticated fair-faced concrete projects would not be possible without high-quality manufacturing equipment. Following an intensive comparison of products from numerous manufacturers, Inshaa Precast chose the German machine and plant manufacturer Weckenmann Anlagentechnik to supply the urgent



■ Daniel Breitbach
Regional Director Middle East & Asia
Weckenmann Anlagentechnik GmbH & Co.
KG, Germany
Daniel.Breitbach@weckenmann.de

ly needed tilting table production for the expansion of the existing production capacities.

The modern Weckenmann tilting tables impressed Inshaa Precast with several fundamental strengths and advantages:

- The tilting table consists of a special German-made shuttering sheet with a very high flatness quality and a polished forming surface.
- Modern high-frequency vibrators underneath the tilting table ensure very



Works manager Musthaq Ahmed Khan praises the high quality of the Weckenmann tilting table production.



The modern Weckenmann tilting tables impress with their German-made quality.

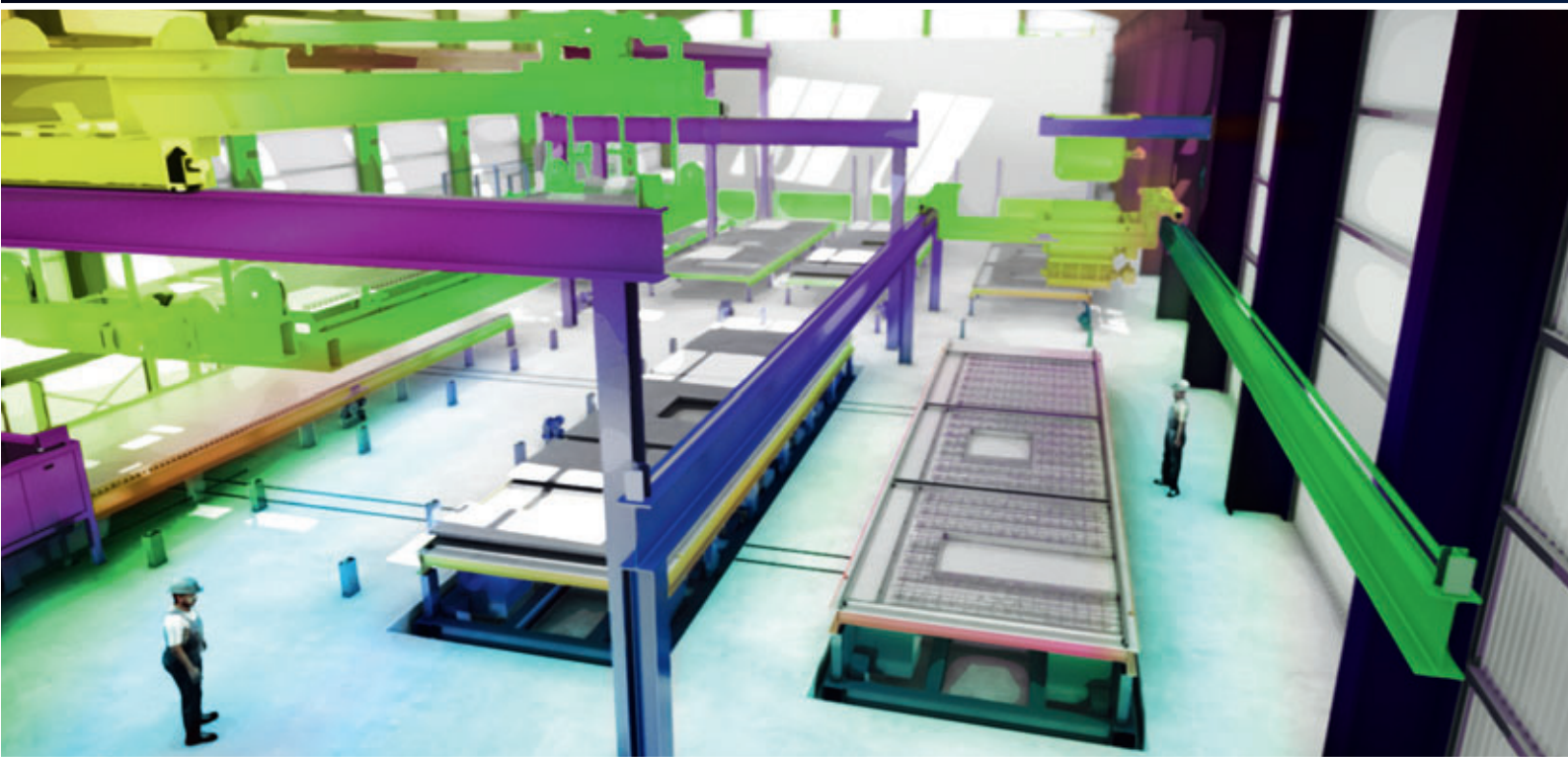

EFFICIENT PRECAST CONCRETE PLANTS THROUGH MODERN PLANT SYSTEMS

Benefit from customer-specific complete solutions of the technology leader

Our customized plant engineering planning adjusts machines and components to the manufacturing processes and the production program in an optimum manner. For this reason, our economic plant systems set manufacturing standards in the industry.

Weckenmann is a system supplier for new plants and partner for the modernization of existing precast concrete plants: www.weckenmann.com



Inshaa Precast concentrates in the modern tilting table production on sophisticated architectural concrete projects such as wall elements and perimeter walls as well as the manufacture of structural precast elements

good concrete compaction. The speed of the vibrator is infinitely adjustable by means of a frequency converter. Damping elements built into the substructure minimise noise emissions and the transmission of vibrations.

- The shuttering sheet is welded to a stable and torsionally rigid substructure. The tilting table is bolted securely to the floor.
- Weckenmann tilting tables are provided with sturdy hydraulics with safety devices in the form of non-return valves to prevent inadvertent lowering and a synchronising module for synchronous movement of the hydraulic cylinders.
- Edge shuttering profiles that are infinitely adjustable in height are possible on request. These are defined together with the customer.
- In addition, heating coil tubes can be integrated on request for the homogeneous and energy-saving heating of the precast elements.
- Weckenmann tilting tables are manufactured according to the customer's requirements and can be adapted individually to the most diverse load requirements.

Leading shuttering and magnet technology

In order to guarantee a fast and efficient shuttering process and to protect the high-quality steel sheets of the new tilting tables, Inshaa Precast additionally opted for the high-quality and durable magnet boxes from the Swabian precast plant experts. Shuttering expert Benjamin Zeh explains the advantages of the flexible X-Uni shuttering system: "Customers who wish to meet different shuttering requirements flexibly using timber or steel profiles can use our X-Uni system as the basis. We will gladly assist our customers in developing a suitable shuttering system for overcoming individual challenges."

Looking to the future

Works manager Musthaq Ahmad Khan is satisfied with the new production. Thanks to the new tilting table production from Weckenmann, Inshaa Precast has succeeded in considerably expanding production capacities to a high quality level. The company is equipped for the future and ready to successfully implement further new building projects. ■

FURTHER INFORMATION

شركة إنشاء للمنتجات الخرسانية
Inshaa Company For Concrete Products

Inshaa Factory For Concrete Products.
P.O.Box 523,
Al-Khobar - 31952, Saudi Arabia
info@inshaaprecast.com
www.inshaaprecast.com



Weckenmann Anlagentechnik GmbH & Co. KG
Birkenstraße 1
72358 Dormettingen, Germany
T +49 7427 94930, F +49 7427 949329
info@weckenmann.de, www.weckenmann.de